



Gun Plain Charter Township
381 8th St.
Plainwell, MI 49080

**COMMUNITY SURVEY
GUN PLAIN CHARTER TOWNSHIP
P.O.BOX 146
381 8th STREET
PLAINWELL, MI 49980**

Second Fold

Second Fold

**GUN PLAIN TOWNSHIP
2008 Land Use Plan Update Community Survey**

The Gun Plain Charter Township is in the process of updating the Township's Land Use/Master Plan used to help guide future growth and development in the community. We are seeking the opinions of Township residents and property owners about certain development related issues. Your participation in this survey will assist the Planning Commission and Township Board in making land use and development related policies and decisions.

Please take a few minutes to complete this survey. When you are finished, either mail (the postage is paid) or hand deliver it to the Township offices. If several individuals at your address would like to complete a survey, the form may be photocopied, an extra picked up at the Township offices or it may be printed off the internet from Township's website (www.gunplain.org). Your replies will remain anonymous. Please return the survey by July 15, 2008. Thank you for your time and prompt response. If you have any questions, please feel free to call (269)-685-9471

Gun Plain Charter Township Planning Commission

First fold

First Fold

1. **Do you live in the Township?** Yes ____ No ____ **If yes, for how many years?** ____
2. **Your house is located:**

a. ____ on a lot in a subdivision (plat or site condominium)	d. ____ on a parcel over 5 acres that is not farmed
b. ____ on a parcel of less than 2 acres	e. ____ on a working farm
c. ____ on a parcel of 2-5 acres	
3. **Should commercial (retail and services) development be accommodated beyond the commercial development pattern already established on the outskirts of Plainwell and near the Airport?** Yes ____ No ____
4. **If yes to #3 , where should commercial development be encouraged?**
 - a. ____ Further south along Douglas Avenue (South 10th St.).
 - b. ____ East of Plainwell on M-89.
 - c. ____ Near 2nd St. on M-89
 - d. ____ North 10th St. (North of Plainwell)
 - e. ____ Other (Specify) _____
5. **How important to you are the following? (check level of importance for each)**

	<u>Not</u> <u>Important</u>	<u>Important</u>	<u>Very</u> <u>Important</u>
a. Preserving the integrity of farmland and agri-business	_____	_____	_____
b. Maintaining the rural character and open space of the Township	_____	_____	_____
c. Improving public safety services	_____	_____	_____
d. Enforcing Township zoning and junk regulations	_____	_____	_____
e. Maintaining and improving roads	_____	_____	_____
f. Increasing housing opportunities for young families	_____	_____	_____
g. Increasing housing opportunities for senior citizens	_____	_____	_____
h. Surface and ground water quality	_____	_____	_____
i. Lack of public water	_____	_____	_____
j. Failing septic systems	_____	_____	_____
k. Lack of commercial and industrial tax base	_____	_____	_____
l. Commercial strip development along major roads	_____	_____	_____

6. In order to provide for capital items (such as parks, roads, etc.) and/or improved services, would you be willing to pay additional taxes to the Township for any of the following?

	<u>Yes</u>	<u>No</u>	<u>No Opinion</u>
a. Public water	_____	_____	_____
b. Public sewer	_____	_____	_____
c. Police protection	_____	_____	_____
d. Fire protection	_____	_____	_____
e. Road paving/better maintenance	_____	_____	_____
f. Emergency medical services	_____	_____	_____
g. Bike paths/walking paths	_____	_____	_____
h. Parks and Recreation (picnic areas, playgrounds, play fields, tennis courts etc.)	_____	_____	_____

7. Mixed-Use developments are a form of development which promotes the interaction of a variety of land uses within close proximity on the same development parcel. The uses can include higher density residential, office uses, civic uses, gathering space and limited commercial and light industrial activities. Persons living in mixed use developments often have the opportunity to live and work and shop in the same, walkable neighborhood. To allow such developments, flexible zoning regulations must be in place and urban infrastructure, such as water or sewer facilities, must be available.

With regard to "mixed use" developments, please select a response to the following statement.

"The Township should adopt development standards that will enable developers to propose the creation of mixed use developments within areas of the Township that have already been planned for increased development activity".

Agree _____ Disagree _____ No opinion. _____

8. At the present time Gun Plain Township does not own land that is unrestricted and capable of being developed for long term parks and recreational use. The Township does however, contribute financially to the recreation program sponsored by Plainwell Community School's Community Education Department. This contribution is typically in the \$6,000 to \$7,000 range annually and is used to ensure that Township residents have access to the high quality youth, senior citizen and other recreation programs offered by the school district, primarily at school facilities.

With regard to parks and recreation planning, please select a response to the following statement.

"Rather than acquiring land and eventually developing their own parks and recreational facilities, Gun Plain Township residents should continue to rely on nearby city, county and school facilities.

Agree _____ Disagree _____ No Opinion _____

9. Irrespective of ownership or jurisdiction (school, city, township or private), what types of park facilities would you like to see within the community?(select all that apply)

- | | | |
|-------------------------------|---|----------------------------|
| a. _____ Nature trails | d. _____ Softball/soccer fields | g. _____ Basketball courts |
| b. _____ Picnic area | e. _____ Paved trail for bicycling/roller blading | h. Other _____ |
| c. _____ Playground equipment | f. _____ Tennis courts | _____ |

10. On the map below, please indicate the quadrant of the Township in which you live or own property by circling the appropriate quadrant label.

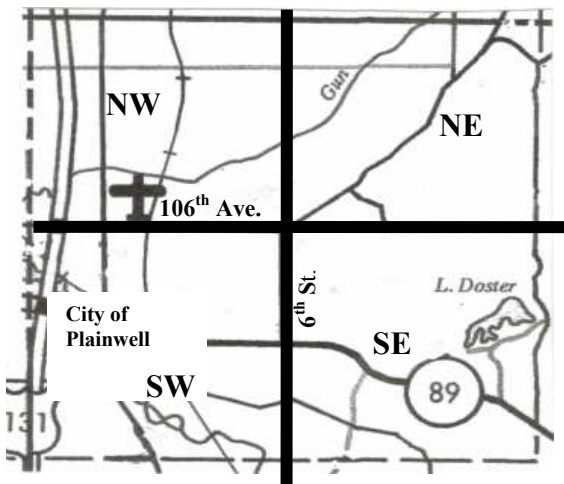

NW NE SE SW

Please use the following space to include any comments or suggestions that you may have pertaining to Township planning and development?

Thank you for completing the survey. Please return it by re-folding the form so that the panel with the return address and postage stamp is showing. Tape or staple it together in the locations indicated at the top. Then just drop it in the mail.